



FAG

2207-2RS-TVH

Self-aligning ball bearing

Schaeffler ID:
0167028080000Self-aligning ball bearing 22..-2RS-TVH,
seals, plastic cage

Technical information

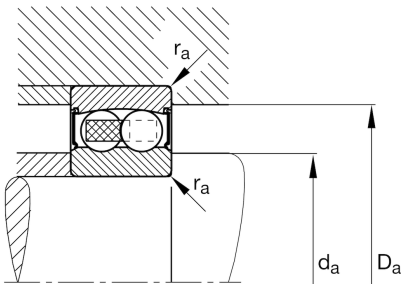
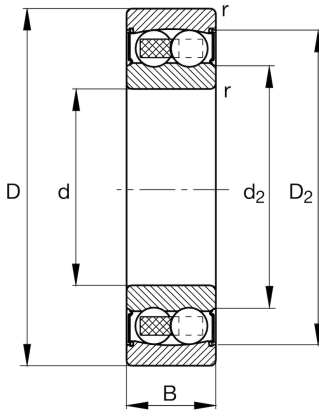
**Main Dimensions & Performance Data**

d	35 mm	Bore diameter
D	72 mm	Outside diameter
B	23 mm	Width
r_{\min}	1,1 mm	Minimum chamfer dimension
C_r	16.000 N	Basic dynamic load rating, radial
C_{0r}	5.100 N	Basic static load rating, radial
C_{ur}	325 N	Fatigue load limit, radial
n_G	5.600 1/min	Limiting speed
	0,414 kg	Weight

Dimensions

D_2	63,4 mm	Caliber diameter outer ring
d_2	43,5 mm	Caliber diameter inner ring

Mounting dimensions

$d_{a \min}$	42 mm	Minimum diameter shaft shoulder
$D_{a \max}$	65 mm	Maximum diameter of housing shoulder
$r_{a \max}$	1 mm	Maximum fillet radius

Calculation factors

e	0,22	Limiting value of F_a/F_r for the applicability of diff. Values of factors X and Y
Y_1	2,81	Dynamic axial load factor
Y_2	4,35	Dynamic axial load factor
Y_0	2,94	Static axial load factor

Temperature range

T_{\min}	-20 °C	Operating temperature min.
T_{\max}	100 °C	Operating temperature max.